

## IB185230

### INDUCTIVE SENSORS • NORM SWITCHING DISTANCE

Inductive proximity switches are contact-free sensors. They detect all conductive metals, regardless of whether they move or not. The achievable sensing range of the devices depends on the object material and its dimensions. The vibration-resistant sensors can be approached laterally or frontally. Inductive proximity switches are used for presence detection (e.g. goods carriers), positioning (e.g. dampers), counting (e.g. nuts /bolts), speed detection (e.g. for cog wheels), on conveyor systems (e.g. hose feedings) or distance measurements (e.g. press-in checking) of metallic objects.



#### MECHANICAL DATA

Active area material of sensor	PA 6.6 (synthetic)
Ambient temperature (MAX)	70 °C
Ambient temperature (MIN)	-25 °C
Degree of protection (IP)	IP67
Housing coating	Nickel-plated
Housing design	Cylinder, screw-thread
Housing material	Brass
Mechanical mounting condition for sensor	Flush
Pressure-proof	No
Sensor length	80 mm
Thread pitch	1 mm
Thread size, metric	18
Wire cross section	0.5 mm <sup>2</sup>

#### ELECTRICAL DATA

Cascadable	No
Hysteresis	15 %
Max. output current	350 mA
Norm measuring plate	18x18x1
Number of pins	3
Relative repeat accuracy	5 %
Suitable for safety functions	No
Supply voltage (MAX)	250 V
Supply voltage (MIN)	20 V
Switching distance	5 mm
Switching frequency	30 Hz
Type of electrical connection	MC-connector
Type of switching function	Breaker contact
Type of switching output	Two-wire
Voltage drop	5 V
Voltage type	AC/DC

**ELECTRICAL DATA**

With monitoring function of downstream devices

No

**CONNECTION**

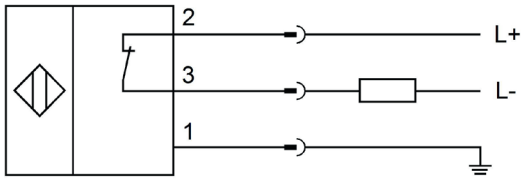

**Colors:** 1 = GN (green), 2 = RD/BK (red/black), 3 = RD/WH (red/white)

**Functions:** 1 = PE, 2 = L+, 3 = L-

**DIMENSIONAL DRAWING**

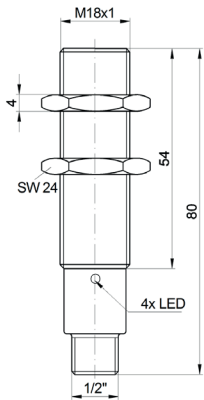

**INSTALLATION**



Mounting / Installation may only be carried out by a qualified electrician!

**DISPOSAL**



**SAFETY WARNINGS**

Before initial operation, please make sure to follow all safety instructions that may be provided in the product information!

Never use these devices in applications where the safety of a person depends on their functionality.