

IB25C819

INDUCTIVE SENSORS • NORM SWITCHING DISTANCE

sensor inductive, 50x10x25mm, Flush, Sn: 6, 10-35V DC, -40-85°C, PNP NO, Cable connector 1.14m PUR (Polyurethane), IP67, PA 6.6 (synthetic)



MECHANICAL FEATURES

Active area material of sensor	PA 6.6 GF25
Ambient temperature	-40 °C ... 85 °C
Cable infeed	Axial
Cable length	1.14 m
Degree of protection (IP)	IP67
Design	Cuboid
Housing material	PA 6.6 (synthetic)
Material of cable sheath	PUR (Polyurethane)
Mechanical mounting condition for sensor	Flush
Number of cores	3
Pressure-proof	-
Sensor height	50 mm
Sensor length	10 mm
Sensor width	25 mm
Wire cross section	0.5 mm ²

ELECTRICAL FEATURES

Cascadable	-
Hysteresis	15 %
No-load current	13 mA
Operating voltage	10 V ... 35 V
Rated switching current	200 mA
Relative repeat accuracy	5 %
Reverse polarity protection	+
Short-circuit protection	+
Suitable for safety functions	-
Switching distance	6 mm
Switching frequency	800 Hz
Type of electrical connection	Cable connector
Type of switching function	Normally open contact
Type of switching output	PNP
Voltage drop	2.4 V
Voltage type	DC

Other

Packaging dimensions	300mm x 60mm x 410mm
Shipping weight	0.08kg
Tariff code	85365019

Classification

ipf product group	700
eClass 8.0	27270101
eClass 9.0	27270101
eClass 9.1	27270101
ETIM-5.0	EC002714
ETIM-6.0	EC002714
ETIM-7.0	EC002714

Connection

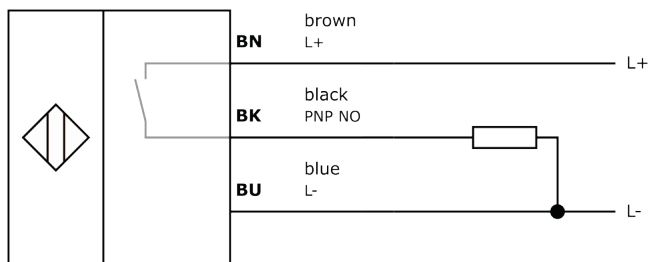

Dimensional drawing

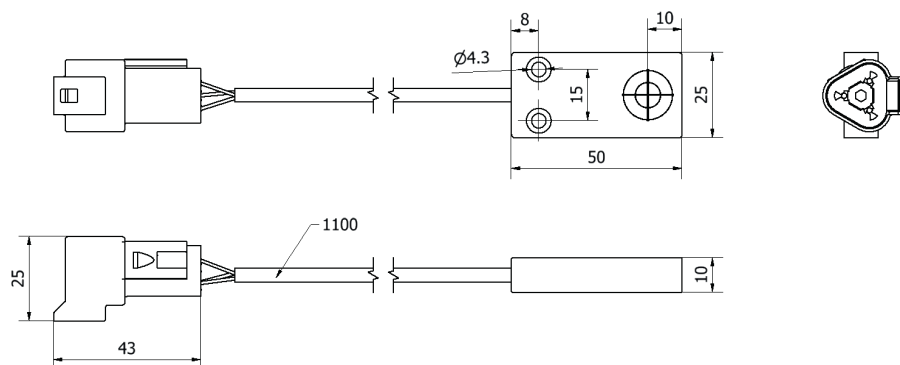

Installation



Mounting / installation may only be carried out by a qualified electrician!

Disposal



Safety warnings

Before initial operation, please make sure to follow all safety instructions that may be provided in the product information. Never use these devices in applications where the safety of a person depends on their functionality. LED lighting systems can generate intensive UV radiation, which can damage your eyes in case of improper use. The manufacturer cannot be held responsible for damages that result from improper use or connection.