

CM030980

COUNTERS • MULTI-FUNCTION COUNTERS



MECHANICAL DATA

Ambient temperature (MAX)	65 °C
Ambient temperature (MIN)	-20 °C
Degree of protection (IP)	IP65
Height	48 mm
Housing material	Polycarbonate
Length	106.6 mm
Mounting method	Front mounting
Storage temperature	75 °C
Storage temperature	-25 °C
Width	48 mm

ELECTRICAL DATA

Adding	Yes
Counting frequency	55 kHz
Display	LCD
Max. output current 1	3 A
Max. output current 2	3 A
Number of decades	12
Number of pins	13
Number of presets to be set	2
Number of switching outputs	2
Operating voltage (MAX)	30 V
Operating voltage (MIN)	10 V
Power consumption	4.5 W
Primary voltage	24 V
Pulse counter	Yes
Rated control supply voltage Us at DC (MAX)	30 V
Rated control supply voltage Us at DC (MIN)	10 V
Subtracting	Yes
Switching capacity	30 VA
Switching current	3 A

ELECTRICAL DATA

Switching voltage	250 V
Timed output	99.99 s
Transducer power supply current	80 mA
Transducer power supply voltage	24 V
Type of 2nd switching function	Change-over contact (NO/NC)
Type of 2nd switching output	Relay contact
Type of electrical connection	Screw connection
Type of signal input A	PNP/NPN
Type of signal input B	PNP/NPN
Type of switching function	Change-over contact (NO/NC)
Type of switching output	Relay contact
Voltage type	DC
With elapsed-time counting function	Yes
With quadruple evaluation	Yes
With reset function	Yes

OPTICAL DATA

Background lighting of LC display	Yes
-----------------------------------	-----

OTHER DATA

Number of characters	12
----------------------	----

DIMENSIONAL DRAWING

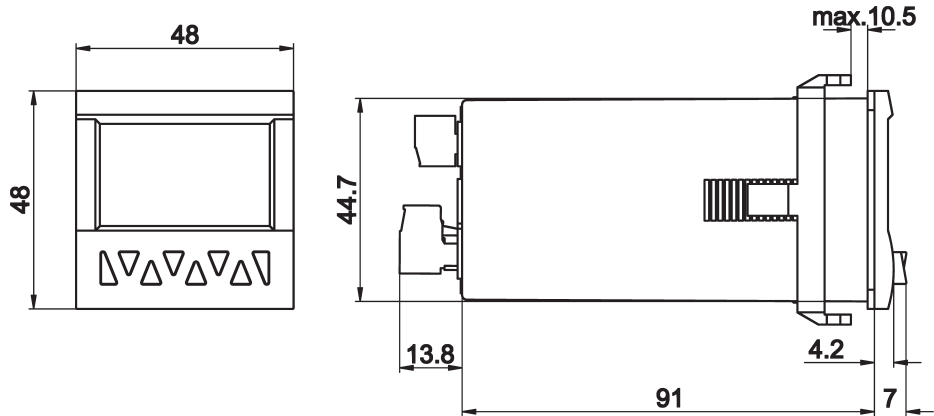

INSTALLATION



Mounting / Installation may only be carried out by a qualified electrician!

DISPOSAL



SAFETY WARNINGS

Before initial operation, please make sure to follow all safety instructions that may be provided in the product information!

Never use these devices in applications where the safety of a person depends on their functionality.