

## IN305230

### INDUCTIVE SENSORS • NORM SWITCHING DISTANCE

Inductive proximity switches are contact-free sensors. They detect all conductive metals, regardless of whether they move or not. The achievable sensing range of the devices depends on the object material and its dimensions. The vibration-resistant sensors can be approached laterally or frontally. Inductive proximity switches are used for presence detection (e.g. goods carriers), positioning (e.g. dampers), counting (e.g. nuts /bolts), speed detection (e.g. for cog wheels), on conveyor systems (e.g. hose feedings) or distance measurements (e.g. press-in checking) of metallic objects.

#### MECHANICAL DATA

Active area material of sensor	PA 6.1
Ambient temperature	-25 °C ... 70 °C
Cable length	2 m
Degree of protection (IP)	IP67
Housing coating	Nickel-plated
Housing design	Cylinder, screw-thread
Housing material	Brass
Material of cable sheath	PVC
Mechanical mounting condition for sensor	Non-flush
Pressure-proof	No
Sensor length	80 mm
Thread pitch	1.5 mm
Thread size, metric	30
Wire cross section	0.5 mm <sup>2</sup>

#### ELECTRICAL DATA

Cascadable	No
Hysteresis	15 %
IO-Link compatible	No
Max. output current	350 mA
Min. output current	2 mA
Norm measuring plate	30x30x1
Number of pins	3
Relative repeat accuracy	5 %
Short-circuit-proof	Yes
Suitable for safety functions	No
Switching distance	15 mm
Switching frequency	30 Hz
Type of electrical connection	MC-connector
Type of switching function	Breaker contact
Type of switching output	Two-wire

## ELECTRICAL DATA

Voltage drop	5 V
Voltage type	AC/DC
With monitoring function of downstream devices	No

## CONNECTION

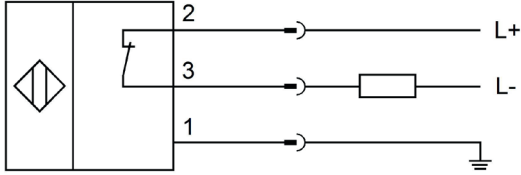

**Colors:** 1 = GN (green), 2 = RD/BK (red/black), 3 = RD/WH (red/white)

**Functions:** 1 = PE, 2 = L+, 3 = L-

## DIMENSIONAL DRAWING

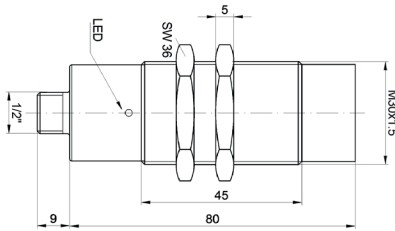

## INSTALLATION



Mounting / Installation may only be carried out by a qualified electrician!

## DISPOSAL



## SAFETY WARNINGS

Before initial operation, please make sure to follow all safety instructions that may be provided in the product information!