

dimensions  $\varnothing 6.5$   
 switching distance non-flush 6mm

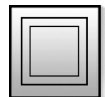

- ✓ non-flush
- ✓ integrated amplifier
- ✓ short-circuit and reverse polarity protected
- ✓ M8-connector

**increased switching distance  
 stainless steel housing**



### Technical Data

IN060186

nominal switching distance	6mm
mounting	non-flush
operating voltage	6 ... 36V DC
current consumption (w/o load)	12mA
short-circuit protection	+
reverse polarity protection	+
output signal	PNP, NO
output current (max. load) voltage	100mA
drop (max. load)	2.0V DC
switching hysteresis	3 ... 20%
LED-display	+
temperature drift	$\pm 10\%$ (0 ... +60°C) / $\pm 15\%$ (-25 ... +75°C) <
response time	0.5ms
correction factors	steel: 1.0 stainl.steel: 0.8 aluminum: 0.5
temperature (operating)	+25 ... +75°C
material (housing)	chromium-nickel steel
material (active surface)	PBT
length	46mm
protection class (EN 60529)	IP67
connection	M8-connector, 3-pin
connection accessories	e.g. VK200075
mounting accessories (quick clip)	AY000046

### connection

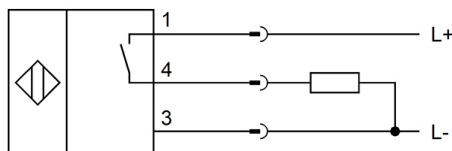

**wire colors:**  
 1 = BN (brown), 3 = BU (blue), 4 = BK (black)

**functions:**  
 1 = L+, 3 = L-, 4 = PNP NO

### dimensional drawing

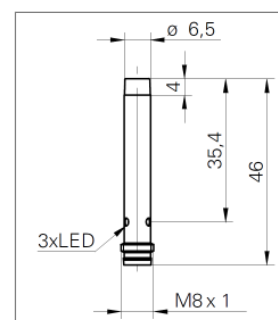

### correction factors (guide values) when mounted in:

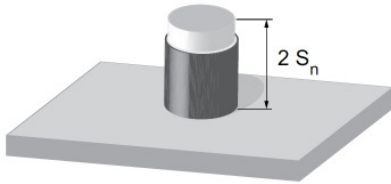

steel:	1,0
stainless steel:	1,0
aluminum:	1,0

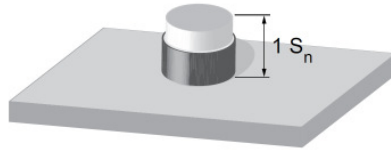

steel:	1.10
stainless steel:	0.95
aluminum:	0.90

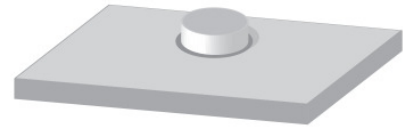

steel:	not possible
stainless steel:	0.95
aluminum:	0.80

### mounting arrangement

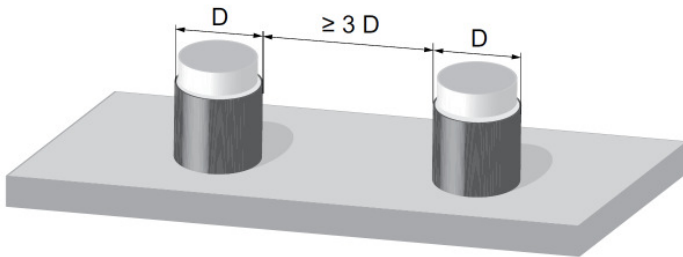

article no.: **IN060186**

**Warning:** Never use these devices in applications where the safety of a person depends on their functionality.