

capacitive sensor

PRODUCT: sensor label detection

DESIGN: 63x49x32mm

- **robust aluminium housing**
- **LED display**
- **temperature and humidity compensation**
- **short circuit and reverse polarity protection**
- **teach function**



This capacitive label sensor is able to detect all kinds of labels, also transparent labels. Further fields of applications are the detection of double layers, bonding points as well as the examination of cracks in the layer material.

The adjustment is made by two teach buttons. First the layer without label, and then the layer with label will be taught. The taught in values are saved and will not be lost even in case of electrical power outage.

The output function no/nc can also be selected by using the teach buttons. The teach buttons are recessed in order to avoid accidental operation.

technical data

DC

operating voltage	10-30 V DC
current consumption	< 70mA
max. current	200mA
voltage drop	< 2.5V
switching output	pnp, no/nc adjustable
ambient temperature	0 °C ... +60 °C
system of protection [EN 60529]	IP 65
connection	M8 connector
reproducibility	< 0.05mm
recovery time	100ms
slot width	0.6mm
label length	> 2mm
label interspace	> 2mm
label speed	< 500m/min

adjustment

1. Place the label layer into the sensor slot. The leading edge of the sensor should be flush with the label layer.
2. Place the label interspace under the mark on the leading edge of the sensor.
3. press **teach button 1**.
4. move the layer in running direction until a label is placed under the mark.
5. press **teach button 2**.
6. the teach procedure is now complete. Pressing teach button 2 again, adjusts of the output function (no/nc).

electrical connection

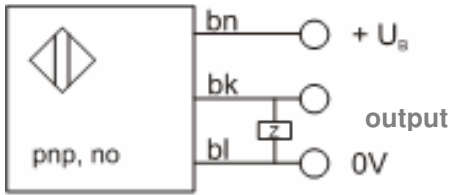

bn=brown, bk= black, bl= blue

dimensional drawings

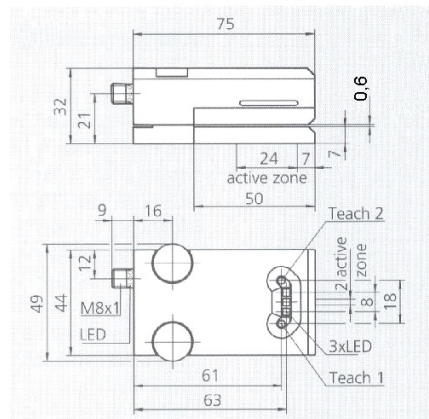
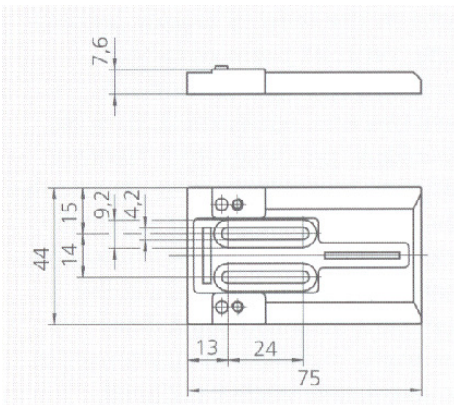

article code: KY991214

Warning: Do never use these devices in applications where the safety of a person depends on their functionality!