

# magnetic sensor

**PRODUCT:** elevator switch AC/DC

**DESIGN:** 89x25x25mm

**ARTICLE CODE:** MY98C706

- 2 year warranty!
- delivery in storage box

## technical data

output	bistable (locking switch)
switching capacity	max. 80W/VA
switching voltage	230V AC/DC
switching current	max. 800mA
switch on time	2.0ms
switch off time	1.0ms
switching frequency	max. 100Hz
lifetime at nominal load	10 <sup>5</sup> to 10 <sup>6</sup> operations
ambient temperature	-25°C ... +80°C
system of protection	IP00
dielectric test voltage ac (rms.) Ui	2000V
status display	LED, south pole at the side
housing material	plastics
electrical connection	2.5m PVC cable / south pole, down, 2x0.75mm <sup>2</sup>

*permissible starting torque of the housing screws (M4) max. 2Nm!*

## electrical connection:

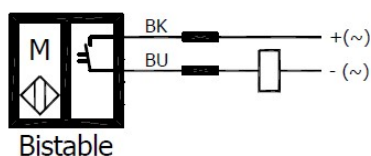

## dim. Drawing:

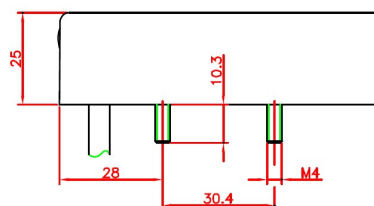
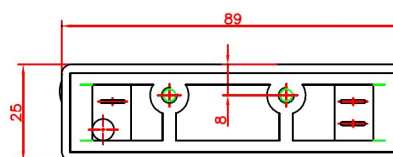

**Warning:** Never use these devices in applications where the safety of a person depends on their functionality.